

# Data Sheet Matrix F12



## Technical data and specifications Matrix F12

Franking speed / Letter thickness:	Recommended for up to 50 letters a day / Letter thickness up to 10 mm.
User interface:	Touchscreen monochrom display, 18 programmable OneTouch functions (quick access to postal products).
Scales / Tariff calculation:	Online tariff service and downloads, scales 2 kg / 5 kg integrated, space-saving acrylic scale stand, separate interface for 30 kg scales (option), integrated single item weighing mode with Pop-Up weight display, tariff module with quick access to other postal products.
Advertising:	Ink-jet printing technology with HQ high quality printing mode (600 dpi), linking of ad-slogans to accounts, 3 pre-programmed standard slogans (messages), 3 customer-specific ad-slogans (option), 2 self-programmable text messages additional to ad-slogans.
Additional prints:	PPI (Printed Postage Impression), indicia print with or without flexible date, 1D-Barcode for postal services, incoming mail stamp function with date and time (without postage).
Accounts:	9 password protected accounts, expandable up to 25 (option), report print-outs, 1 password protected admin mode.
Interfaces:	IP communication technology (LAN, DHCP, Proxy), Ethernet RJ45 network connection, WLAN via WLAN-Bridge (option).
SmartShop:	Integrated ordering of consumables online via Touchscreen (option).
Comfort functions:	High value warning, automatic date and time change, multi-level energy saving modes with Soft-Off.
Licences / Certificates:	FIPS 140-2 Level 3, IPMAR, CE, BSI-Grundschutz.
Noise level:	Quiet in operation: LPA 1 m: 53 dB(A).
Power consumption:	240 V / 50 Hz, off: 0.44 W, ready to frank: 5.5 W, in Operation: 15 W.

### Recommended daily usage

Up to 50 letters / day

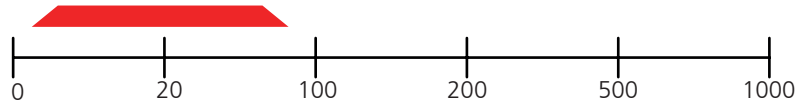

### Envelope format specification (mm)

Envelope dimensions:

height:	min:	96 mm
width:	min:	143 mm
thickness:	min:	0.1 mm
	max:	10 mm

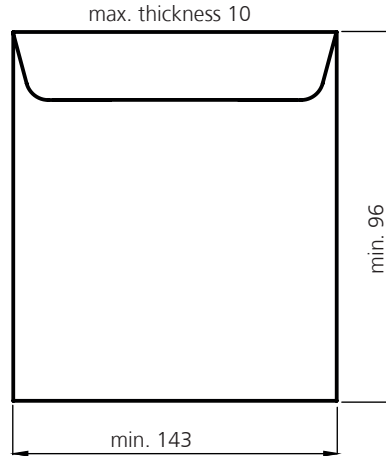

Processible formats (DIN): min: C6 (162 mm x 114 mm)

### Dimensions (mm) and weight

Weight: 4.3 kg (net)

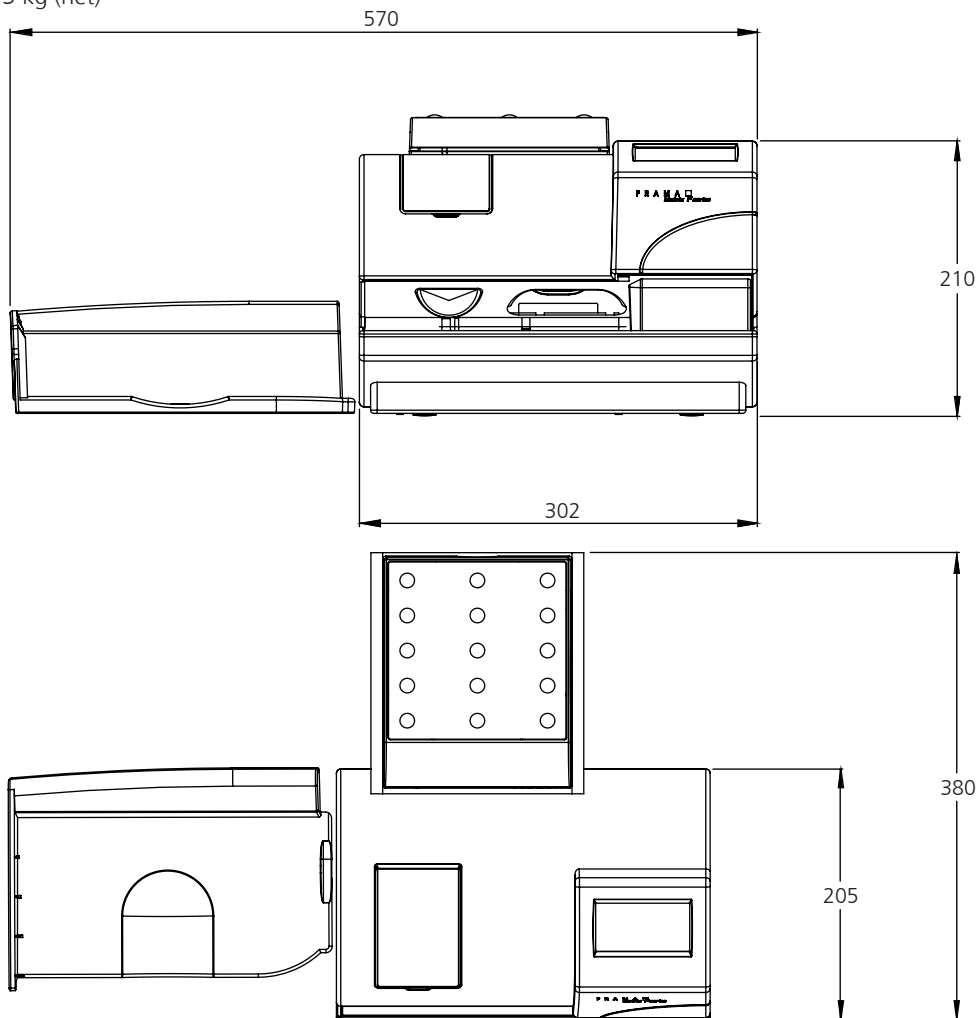

Frama AG  
Dorfstrasse 6  
3438 Lauperswil  
Switzerland